

CITY OF NAPOLEON WATER TAPPING PERMIT FORM

PERMIT #:

ISSUED:

JOB LOCATION: _____

SUBDIVISION NAME: _____ LOT #: _____

OWNER:

ADDRESS: 709 Beckham

CONTRACTOR: _____ PHONE: _____

TAP SIZE: 1" X 1.5" _____ 2" _____ OTHER _____

AMOUNT PAID: _____ YOKE SIZE: _____

PLUMBING CONTRACTOR: _____ PH: _____

DATE OF TAP: 2-28-02 OLD TAP #: 9548 NEW TAP #: 0209

SIZE AND KIND OF MAIN: 12" C-900

LOCATION OF MAIN: 22' South of South pavement DEPTH OF MAIN: 5'

DIST FROM HYDRANT VALVE: 146' E of Hyd 109 DIST TO CURB STOP FROM CORP: 4'

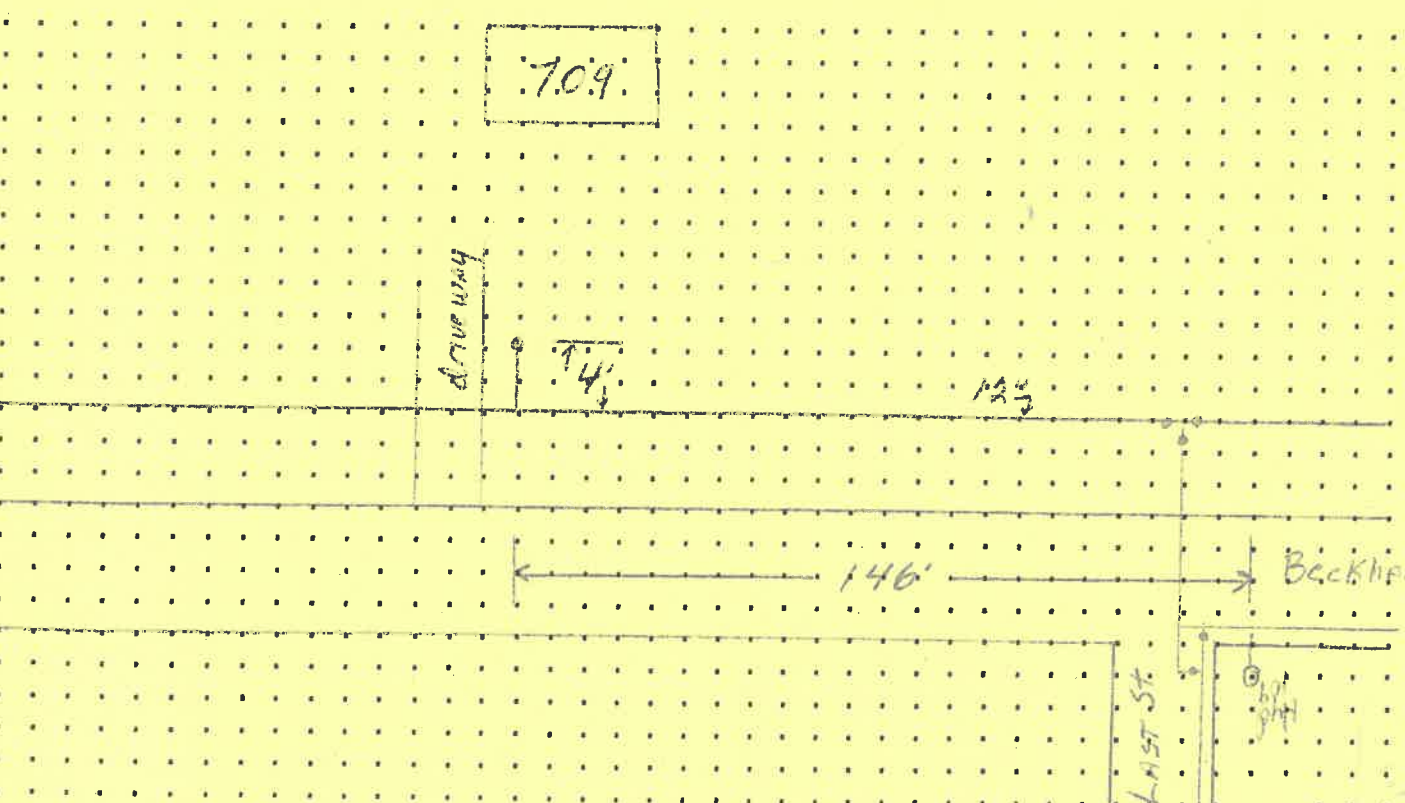

DATE APPROVED: March 13, 2002 BY: [Signature]

WATER TAPPING PERMIT

issued by

The Napoleon Water Distribution Department

255 West Riverview Ave. Napoleon, Ohio 43545 Ph. 592-4010

Permit No. W-0296 Issued _____ Received of _____ (\$ _____).00

(Charge for tapping permit to supply water service to) Lot No. _____ Sub Div. _____

Street No. _____ Tap Size _____ " Cost \$ _____ .00 Plumber _____

Date completed _____ Approved by H. E. Montague water distribution dept. _____ finance director

Name _____ Size of tap 1" Date 12-28-95 Street and No. 709 Beckham

Old Tap No. 1120 New Tap No. 95118 Size and Kind of Main 2" Galv.

Location of Main North edge of pavement Depth of Main 5'

Distance from Hydrant/Valve 156' East of Appl #109 Distance to Curb Stop from Corp. 30'

COMPLETED

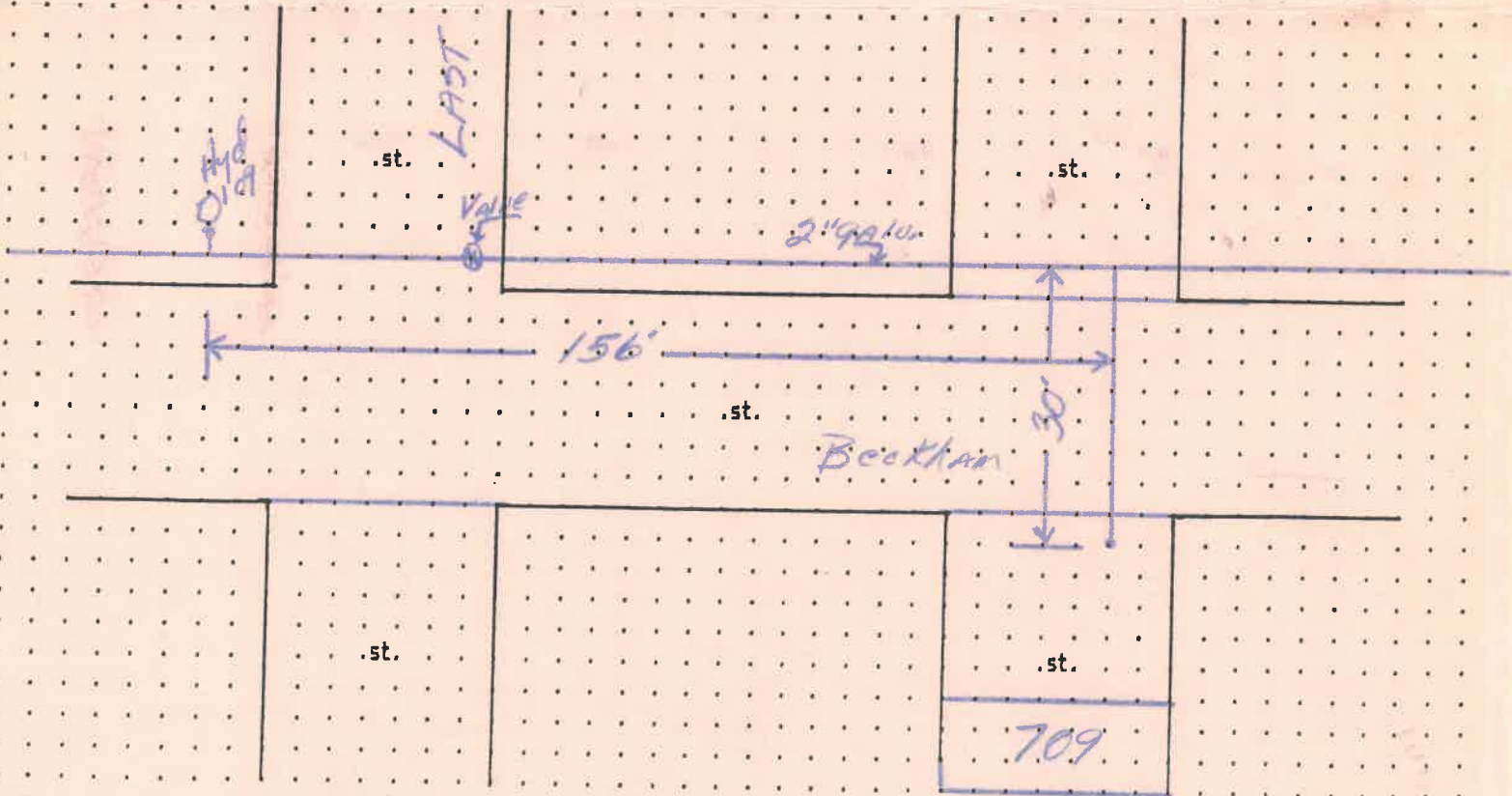

12/28/95

WATER TAPPING PERMIT
 issued by
The Napoleon Water Distribution Department
 255 West Riverview Ave. Napoleon, Ohio 43545 Ph. 592-4010

Permit No. W- 0296 Issued _____ Received of _____ (\$ _____).00

(Charge for tapping permit to supply water service to) Lot No. _____ Sub Div. _____

Street No. _____ Tap Size _____ " Cost \$ _____ .00 Plumber _____

Date completed _____ Approved by Walter E. Montague
 water distribution dept. _____ finance director

Name _____ Size of tap 1" Date 12-28-95 Street and No. 709 Beckham

Old Tap No. 1130 New Tap No. 95118 Size and Kind of Main 2" Galv.

Location of Main North edge of pavement Depth of Main 5'

Distance from Hydrant/Valve 156' East of Hydrant 109 Distance to Curb Stop from Corp. 30'

